

BF0922840

LED FLEX STRIP

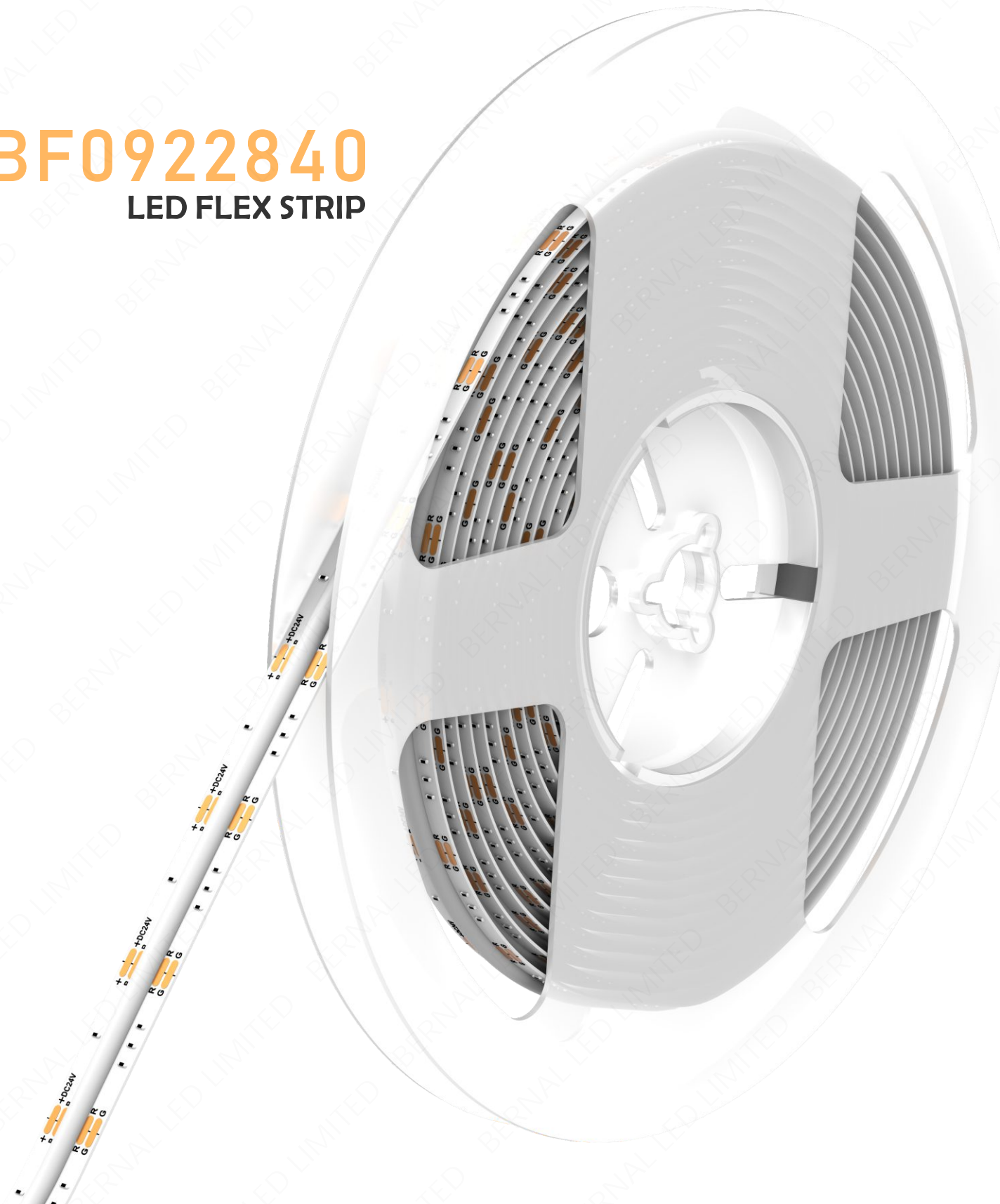

BF0922840

LED FLEXIBLE STRIPS

840-LED/m RGB 24V DC 10mm PCB

bernalLED

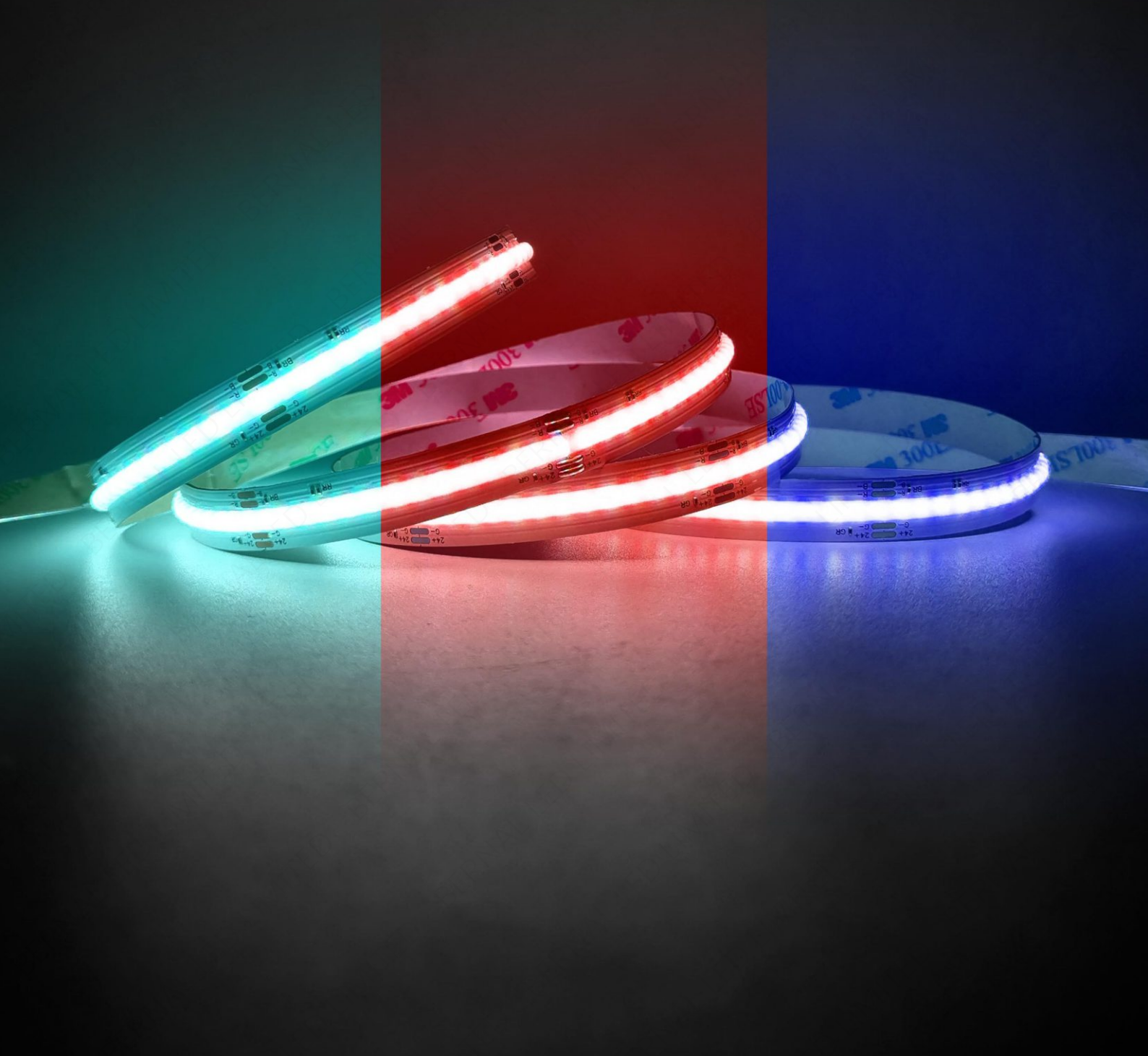

BF0922840

LED FLEXIBLE STRIPS

840-LED/m RGB 24V DC 10mm PCB

bernalLED

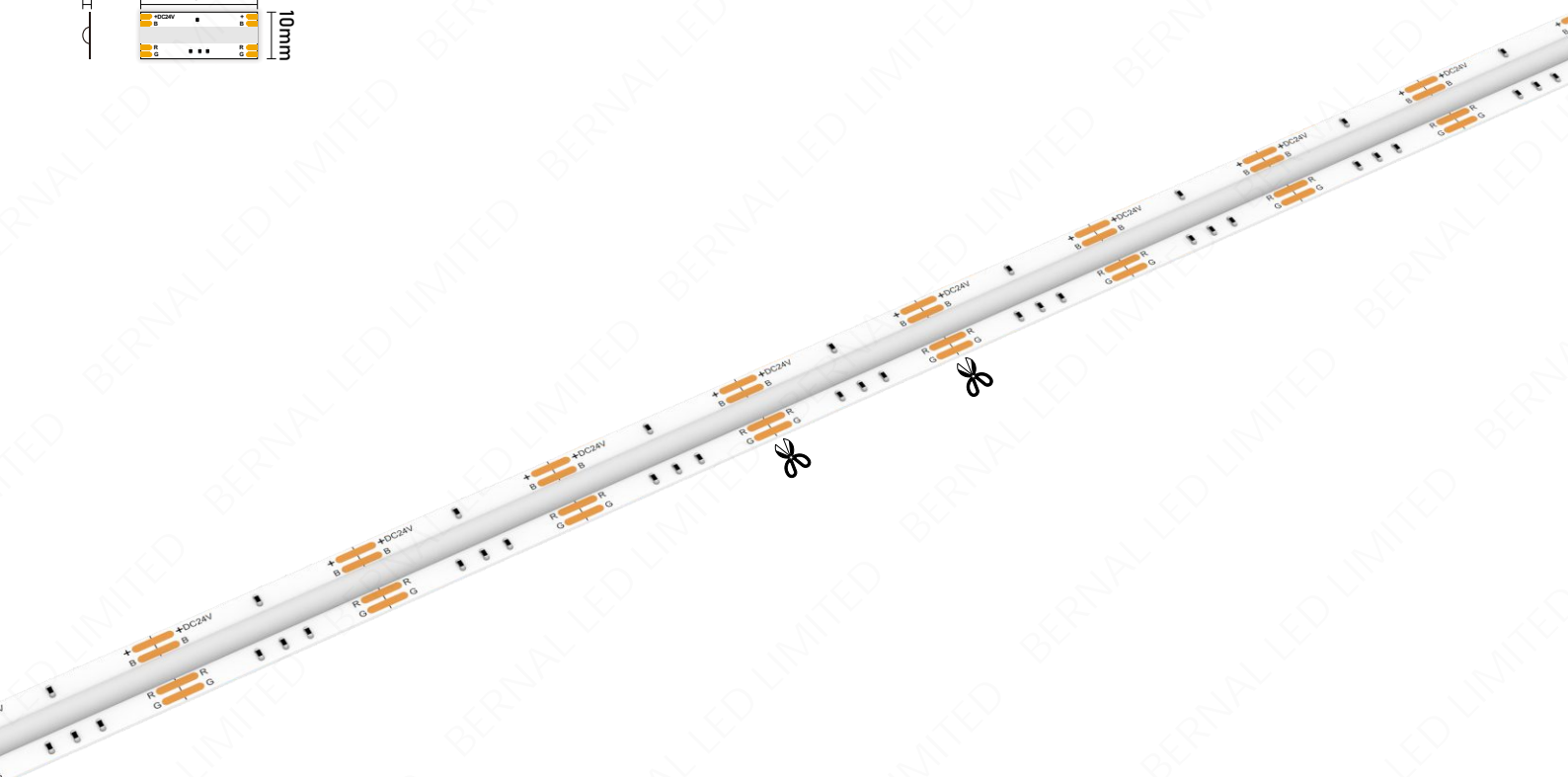
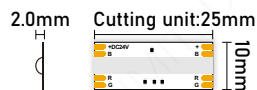

This product is based on our most popular High Quality SAN'AN LED CHIP. This version offers an excellent combination of high light output with a strong color to provide outstanding results. Available in all primary colors to cover most requirements. Supplied in 24V DC as standard for more accurate cut lengths. Bin control for LED color to ensure consistent color throughout all off your orders.

PRODUCT FEATURE & BENEFITS

- ◆ Always using double-layer FPCB, mounted with high quality led Chips
- ◆ Low power requirement & Energy Efficient
- ◆ High-performance FPCB & LED for extremely long life
- ◆ Available in IP20, IP67 rating
- ◆ Great design freedom thanks to flexibility and cuttability of module
- ◆ Easy mounting on many smooth surfaces thanks to self-adhesive tape at the back

PRODUCT CODE

BF	0922	840T	L2	00	S	S	2	00	20
0922 - COB LED	840 - 840 LEDs/m T - RGB color	L2 - 24V DC	00 - no RA	S - SAN'AN LED	S - PCB Width 10mm	2 - PCB 2OZ	00 - RGB	20 - IP20 67 - IP67	

TECHNICAL DATA

LED Brand	SAN'AN LED
Normal Voltage	24V DC
Normal Current per Meter	0.625A/m
Rated Wattage per Meter [Ⓞ]	15W/m
Type of Current	Direct Current / Constant Voltage
Light Color	RGB
Luninous Flux per Meter	696 lm
Luminous Efficacy	/
Color Rendering Index / RA	/
Length per Smallest Cutting Unit	25mm
LED Number per Smallest Cutting Unit	21 LED Chips
Length per roll for package	5 meters / 10 meters / 20 meters
Width of Printed Circuit Board	10 mm
Color of Printed Circuit Board	White
Thickness of Printed Circuit Board	2 OZ
Double Side Adhesive Tape	3M
Temperature Range in Operation	-20℃ ∙∙∙ 70℃
Temperature Range at Storage	-20℃ ∙∙∙ 50℃
Dimmable	Yes
Type of Protection	IP20 / IP67
Life Span	> 50000 Hours

* ⓄMax. power < 16W/m
* Testing environment temperature: 25+2 C
* The actual data of each single product may differ from above typical data which are subject to change without prior notice.

ACCESSORY - FAST CONNECTOR

- COB strip to COB strip



BCNCCB410CSDS

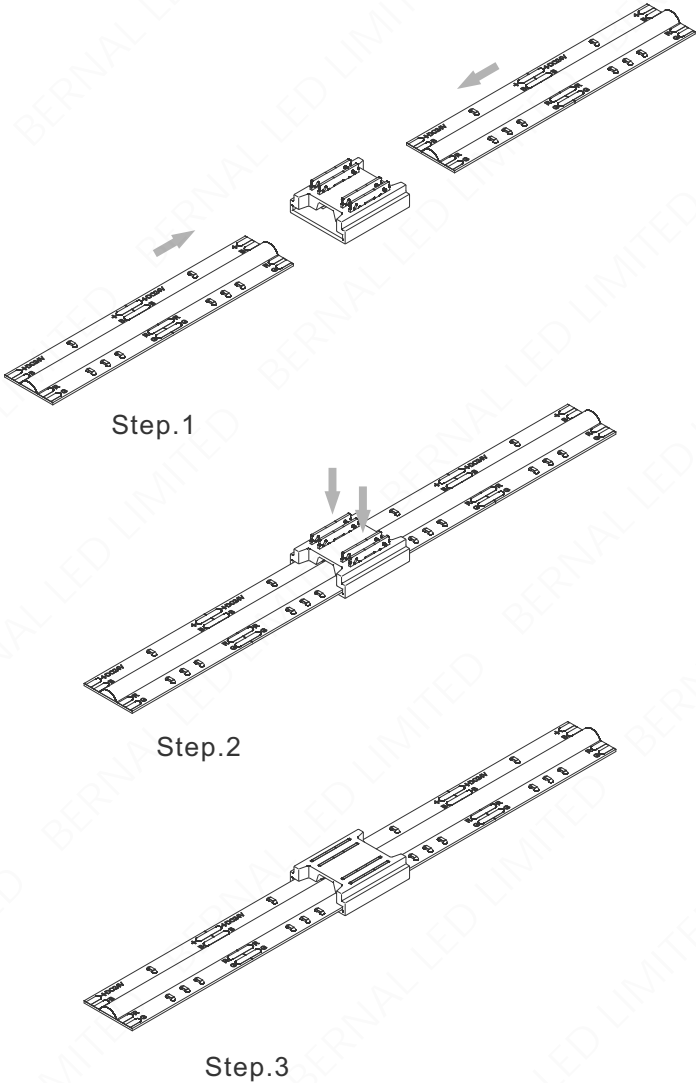
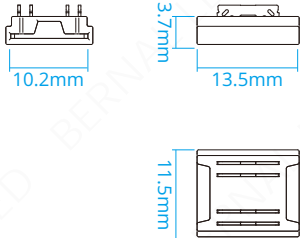

- 1. Push strips into connector
- 2. Press metal plates into connector

SPECIFICATION

PCB Width	10mm
Max. Voltage	36V
Max. Current	5A
Max. Temperature	140°C
Material	Clear PC
Lead Wire	Max. 20AWG
Dimension	13.5x11.5x3.7mm

APPLICATION



ATTENTION



Pay attention on the direction of COB strips, making sure the positive pad connected to positive pad, negative pad connected to negative pad.

* No need to tear off 3M tape before pushing strips into connector.

ACCESSORY - FAST CONNECTOR

- Lead wire to COB strip

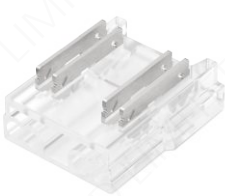
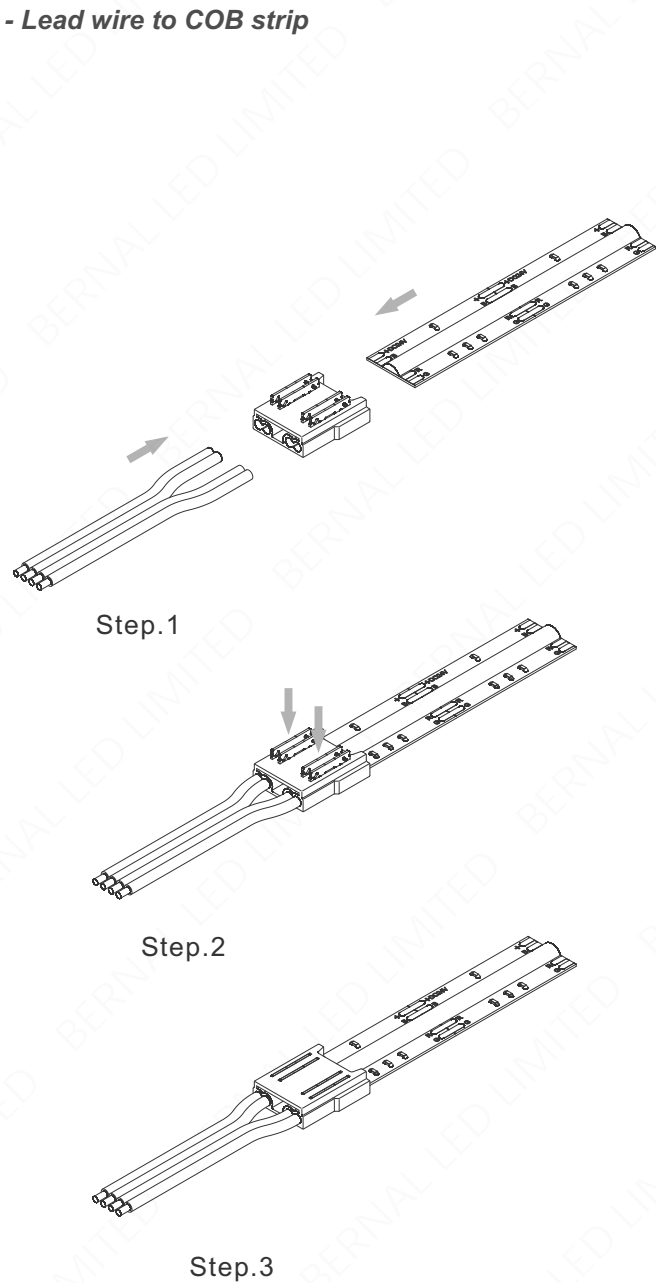

BCNCCB410CSDW

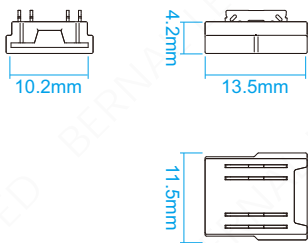

SPECIFICATION

PCB Width	10mm
Max. Voltage	36V
Max. Current	5A
Max. Temperature	140°C
Material	Clear PC
Lead Wire	Max. 20AWG
Dimension	13.5x11.5x4.2mm

APPLICATION

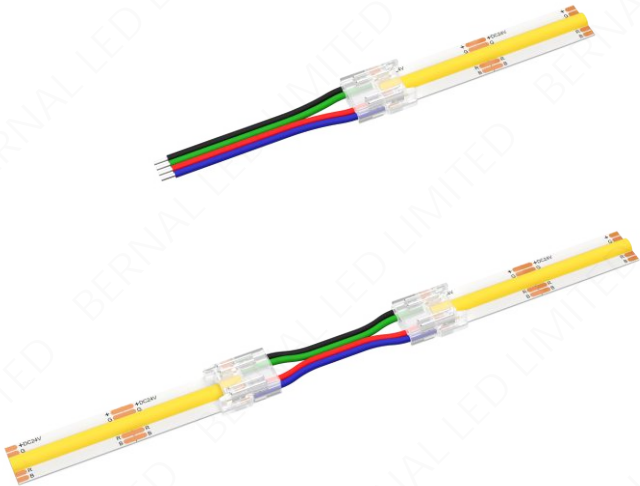

1. Push the lead wire and cob strips into connector
2. Press metal plates into connector



ATTENTION

Pay attention on the direction of COB strips, making sure the positive pad connected to positive pad, negative pad connected to negative pad.

* No need to tear off 3M tape before pushing strips into connector.

CONNECTION SYSTEM

- Basic DIM System

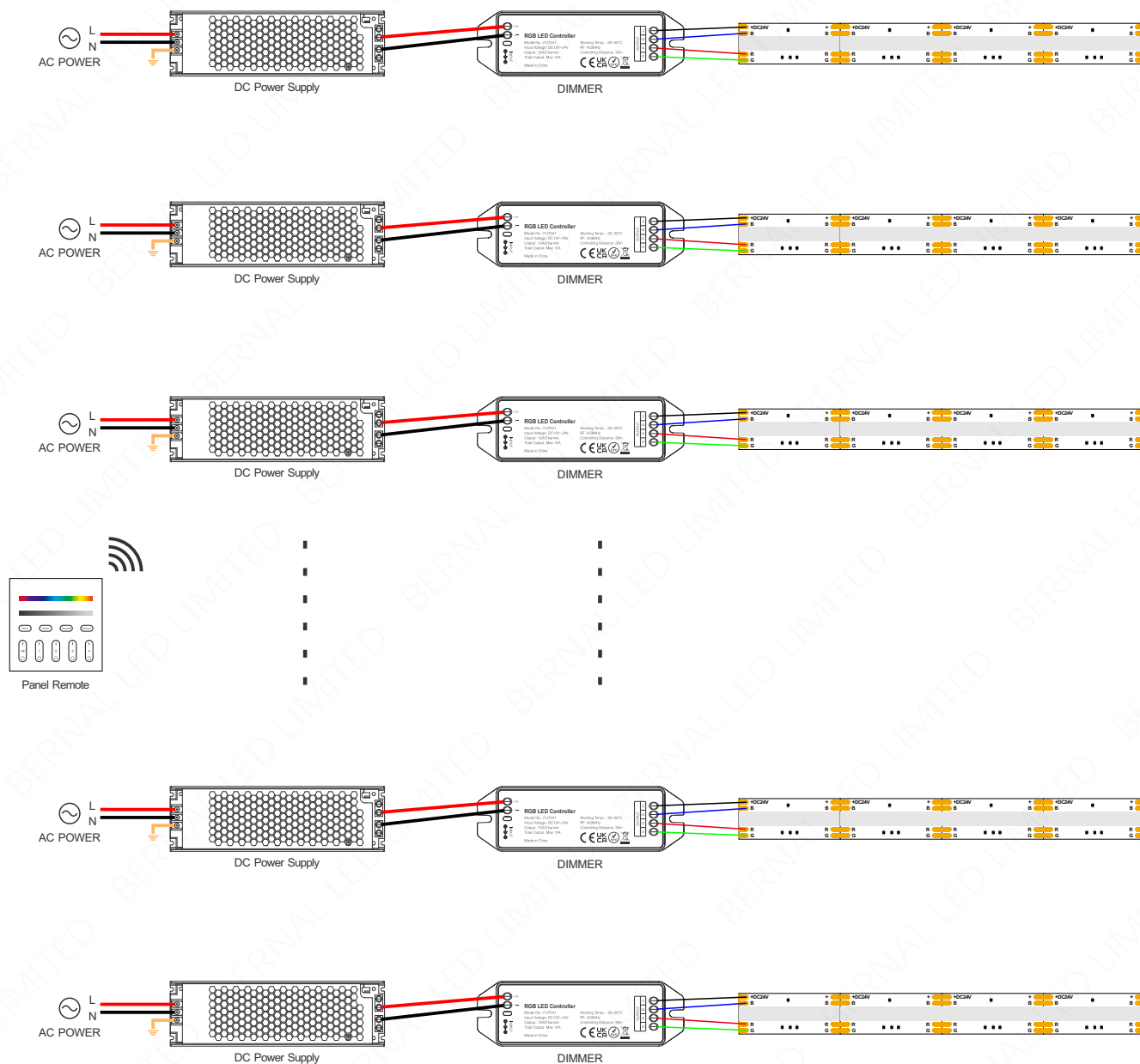

The dimmer can transmit the signals from the remote control to another dimmer within 30 meters. As long as there is a dimmer within 30 meters, the remote control distance can be limitless.

NOTES ON HANDLING

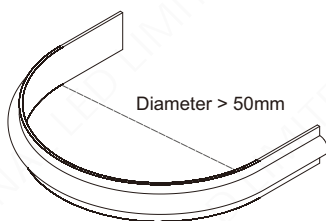

DO NOT bend LED strip to a diameter less than 50mm.

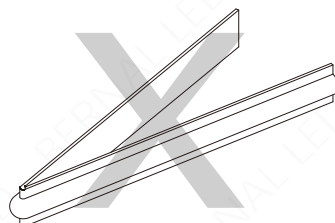

DO NOT fold or crease LED strip

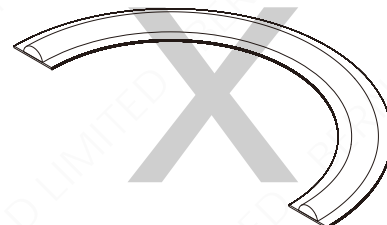

DO NOT bend LED strip on a horizontal plane

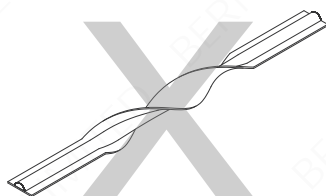

DO NOT over twist LED strip

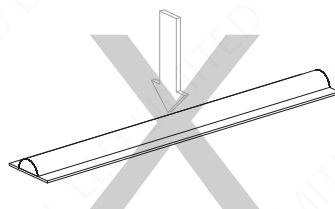

DO NOT put excessive pressure on surface of LED

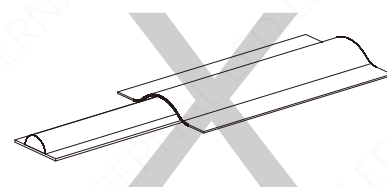

DO NOT cover LED strip with any materials

INSTALLATION INSTRUCTIONS

1. The mounting surface must be clean, dry and free from dust or grease.
2. Release the LED strip from the package and unreel.
3. Measure and cut the LED strip to the required length (only cut at the cut marks with power OFF).
4. Remove the 3M self-adhesive backing tape from the strip gradually during installation.
DO NOT remove it all at once to avoid the strip becoming entangled and sticking to itself.
5. Stick the LED strip to the mounting surface by pressing on the strip in between components only.
DO NOT press on the LEDs or other components on the strip.
6. You can use optional mounting clips to secure the strips at intervals.
7. Once the strip is affixed, it is then ready to be wired.



CAUTION - Twisting, pressing on LEDs, over-bending the strip, cutting at non-cut points, incorrectly powering the strip or exposing a standard strip (IP20) to water, particles or direct sunlight will invalidate the warranty.

SAFTY

1. Installation must be in accordance with local and national electrical code regulations.
2. To ensure safety and correct installation, our strips are intended to be installed by a licensed electrician.
3. Only install with a Constant Voltage LED driver.
4. Each maximum run requires a dedicated power feed from the driver.
DO NOT extend beyond the recommended maximum run length.
5. Make sure the appropriate gauge wire is installed between driver, LEDs, and any dimmers. When choosing wire, calculate voltage drop, maximum amperage rating, and the location ratings on the wire. Improper wire selection and installation could overheat wires and cause fire.
6. **DO NOT** modify product beyond instructions or warranty will be void.



Questions? Please contact us via info@bernal-led.com